

Community Vision

An aerial photograph of the Tomaree Headland coastline. The image shows a lush green headland with a small settlement of buildings at the base. The water is a vibrant turquoise color, indicating a shallow reef flat. The sky is a clear, deep blue. The text is overlaid on the left side of the image, which is partially obscured by a white, torn-paper-like border.

for the future of

Tomaree Headland Port Stephens

Presented by

'The Friends of Tomaree Headland'

March 2019



TOMAREE HEADLAND SHOAL BAY

“An outstanding Natural and Heritage asset which is potentially a Nationally Significant Visitor Attraction located in Port Stephens”

Tomaree Headland



Tomaree Headland is an intrinsic part of the Australian WWII history.

- Accordingly we believe it is necessary to present a much more authentic WWII experience such as the restoration protection and reservation of relics and in particular the need for the establishment of an appropriate museum





Participating Groups of “The Friends of Tomaree Headland”



- Tomaree Business Chamber Inc
- Nelson Bay RSL Sub Branch Inc
- Destination Port Stephens Inc
- Port Stephens Historical Society Inc
- Shoal Bay Community Association Inc
- EcoNetwork - Port Stephens Inc
- Marine Parks Association Inc
- Tomaree Ratepayers & Residents Association Inc

FORT TOMAREE 1942

0 100 200 Metres

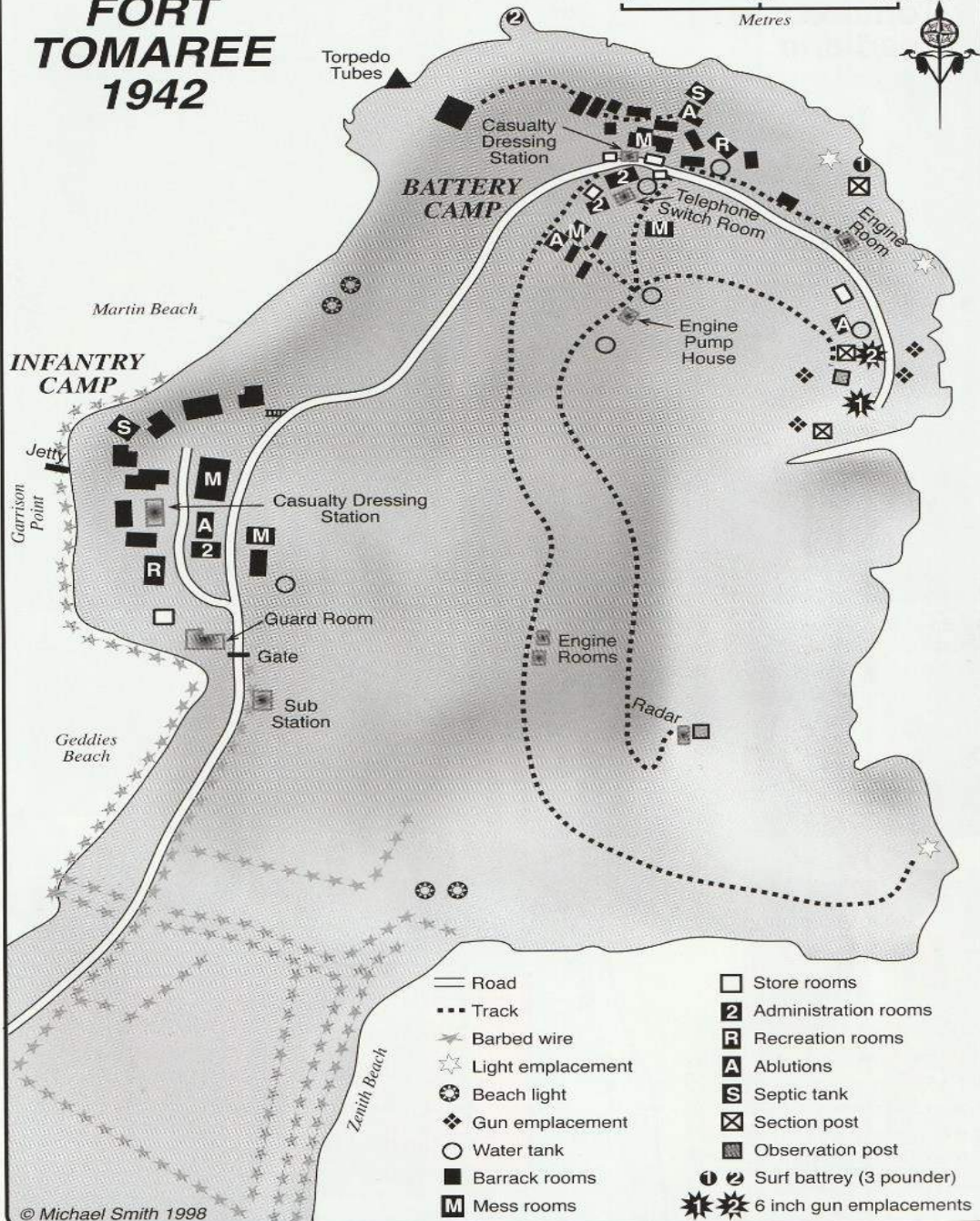

**Lot 453
Tomaree
Lodge**

**Lot 454
Tomaree
Headland**

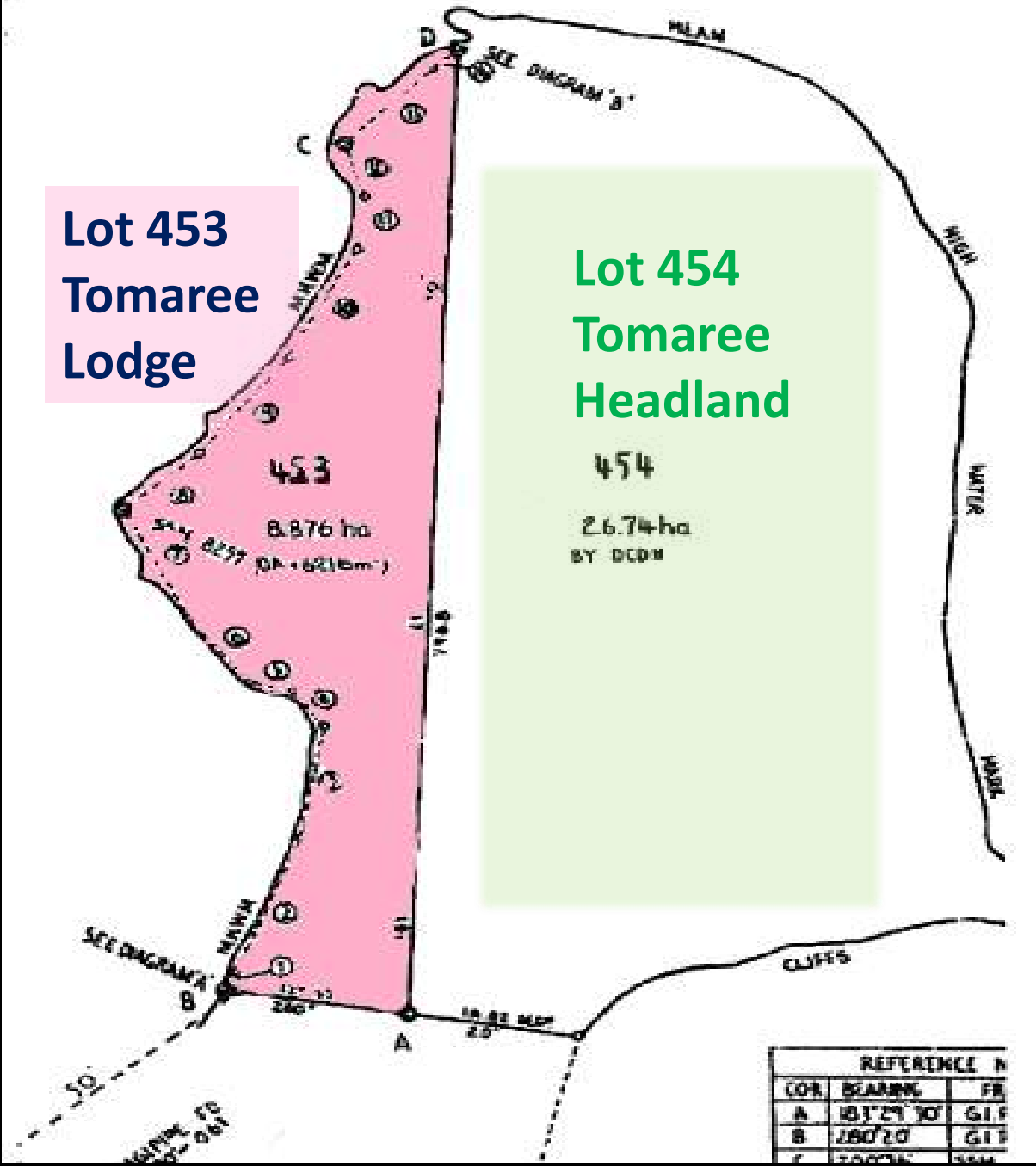

REFERENCE N		
COR.	BEARING	FB
A	181° 29' 30"	61.9
B	280° 20'	61.9
C	200° 00'	30.0



Opportunities



***Military
Museum***



Visitor Interpretation Centre - with theatrette showcasing our cultural History (Worimi, Military, Marine & European History)



Upgrade of Tomaree Lodge Site

- To attract more visitors with possible Cafés, Museums, Eco activities, Tour Operators, Aquarium, Boutique Accommodation, etc



***Re-instating the
Jetty & Baths***



Picnic Areas



***Nature Based
Tourism***



More Opportunities



*Upgrade Walkways
on the Headland*



*Additional access to Headland
'Peak'*



*Upgrade the 'Peak'
Viewing Area*



Upgrade Interpretations



*Provision of Public
Amenities*



Increased Parking

Tomaree Lodge

**Entry
Tomaree
Lodge**

Department of
Ageing, Disability & Home Care
HUNTER RESIDENCE
Tomaree Lodge
A supported accommodation facility
for people with intellectual disability
A SMOKE FREE ENVIRONMENT

**Tomaree
Lodge**



**Pending -
Proposed
Carpark
Site**



**Possible
future
Amenities
Block**



Strong need to Restore, Protect & Preserve WWII Relics



Gun Emplacements



Restored 6" Gun

**What a Relic could look like
after restoration !!**



**WWII Torpedo
Launching Site**

WWII Relic



Achievements to Date by “The Friends of Tomaree Headland”

Bipartisan Support

- For keeping Tomaree Lodge in public ownership

Carpark Agreement Pending

- National Parks & WLS is in discussion with Port Stephens Council to potentially use vacant land on the Tomaree Lodge site for public parking

Amenities Block

- Pending-National Parks in discussion with Port Stephens Council

Friends of Tomaree Headland

- Has grown substantially – now beyond 200

Grant Application submitted

- We have applied for a Grant from the National Maritime Museum to fund (decision by 30th June) an “Assessment and Scoping Study” on the potential future of the Tomaree Lodge site and adjoining Foreshore



Way Forward

- Undertaking a **Scoping Study**
- Need for a **Masterplan**
- To secure the support of all relevant Government Agencies
- Seek funding to **restore WWII Relics**
- Need to **establish** significant **Visitor Interpretation Centre and/or Military Museum and/or Aquarium-Marine Centre**
- **Sustainable Funding Mechanism** and management model to ensure long time viability of the Tomaree Lodge and Headland site
- It is important to **not let the Tomaree Lodge site lay dormant**. (We are informed that it will be vacated by the end of 2019 or early 2020.)
- The **Tomaree National Park has received \$6.7m from the State Government to upgrade the walking track** from Tomaree Headland to Birubi (23 kms) over the next 4 years





Proposed Scoping Study

DRAFT TERMS OF REFERENCE

for a proposed 'SCOPING STUDY'

on the future of the overall Tomaree Headland (including the Lodge)



- Identify the relevant Agencies and interests
- Explore options for the future Administrative and Management responsibilities
- Explore options for future Land Tenure
- Identify the role Port Stephens Council could play
- Identify the opportunities to create a '**Nationally Significant Tourist Attraction**' having regard to the Natural and Heritage Assets including a higher-level presentation of the WW11 history and relics as well as marine and cultural heritage
- Explore possible future funding sources for the various elements of the overall site and in the first instance the Management/Master Plan
- Identify any impediments
- Assess the need for significantly improved Visitor Interpretation and presentation optimising the Visitor experience and maximising the educational opportunities
- The Study should be designed to deliver a Framework and Road Map for the way forward



Many Existing Stakeholders and Potential Stakeholders

for Example:

- National Parks and Wildlife Service
- Family & Community Services
- Marine Park Authority
- Department of Disability Services
- Department of Primary Industry
- Department of Veteran Affairs
- RSL Sub Branch Nelson Bay
- Destinations Port Stephens
- The Community – Residential & Businesses
- Port Stephens Council
- American Embassy
- Australian War Memorial
- Tomaree Lodge Residents Association
- Department of the Environment
- Groups representing ‘Friends of Tomaree Headland

**Tomaree Headland is an outstanding
Natural & Heritage Asset which has the potential to
become a
“ Nationally Significant Tourist Attraction”**





**Would you like to become a friend of
'The Friends of Tomaree Headland'
and have some input, then you can either
phone: 0455 844 751
email: friendsoftomareeheadland@gmail.com**